



- NO CHAIN
- DOWNSTAIRS CLOAKROOM
- GAS FIRED CENTRAL HEATING
- 3 BEDROOMS
- ENSUITE TO MAIN BEDROOM
- DOUBLE GLAZED



23, Westborough Mews
Maidstone, ME16 8TU

£275,000

Situated within a quiet Cul de sac position in a popular neighbourhood , this mid terraced property benefits from being sold with no forward chain.

There is generous family accommodation with allocated car parking.

The property is close to local schools.

The property has a fitted kitchen/ breakfast room with integrated cooker and hob, overhead extractor, fridge/freezer and washing machine.

Downstairs cloakroom . Lounge/Dining Room with patio doors to rear garden. Upstairs you will find two double bedrooms and a good sized third bedroom. The master bedroom has an en- suite shower room. There is a family bathroom.

Early viewing recommended

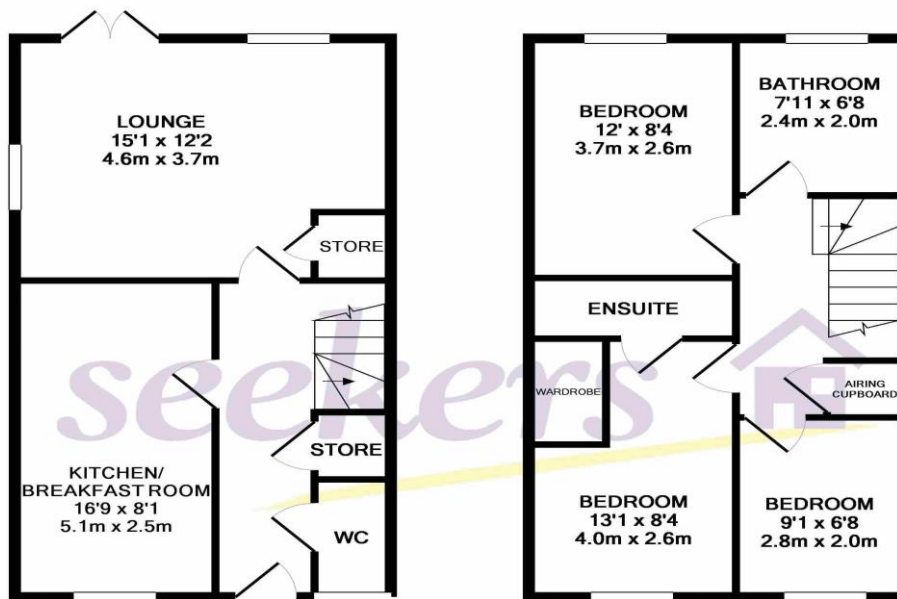

GROUND FLOOR
APPROX. FLOOR
AREA 431 SQ.FT.
(40.0 SQ.M.)

1ST FLOOR
APPROX. FLOOR
AREA 431 SQ.FT.
(40.0 SQ.M.)

TOTAL APPROX. FLOOR AREA 862 SQ.FT. (80.1 SQ.M.)

Whilst every attempt has been made to ensure the accuracy of the floor plan contained here, measurements of doors, windows, rooms and any other items are approximate and no responsibility is taken for any error, omission, or mis-statement. This plan is for illustrative purposes only and should be used as such by any prospective purchaser. The services, systems and appliances shown have not been tested and no guarantee as to their operability or efficiency can be given
Made with Metropix ©2018