



# Breakey & Co



## Scholes, Scholes

**Monthly Rental Of £375**

- One bedroom
- Fully fitted kitchen
- Well presented
- Second floor flat
- Central location
- Close to town centre
- Gas central heating
- Double glazing
- EPC C



# Breakey & Co



## DESCRIPTION

This one bedroom upper-floor flat is in a central location close to local shops, transport links and Wigan town centre. The property is available to let now and offers a spacious lounge, fully fitted kitchen, double bedroom and bathroom with white three-piece suite. Further benefits include gas central heating and double glazing, the property is well presented throughout and is not to be missed.





# Breakey & Co

## ACCOMMODATION

**Lounge** 4.36m (14'4") x 3.55m (11'8")

**Kitchen** 3.43m (11'3") x 2.23m (7'4")

**Bedroom** 3.69m (12'1") x 3.58m (11'9")

**Bathroom** 2.56m (8'5") x 1.63m (5'4")

**Storage** 1.96m (6'5") x 0.98m (3'3")





# Breakey & Co

## Ground Floor

Approx. 47.1 sq. metres (507.3 sq. feet)

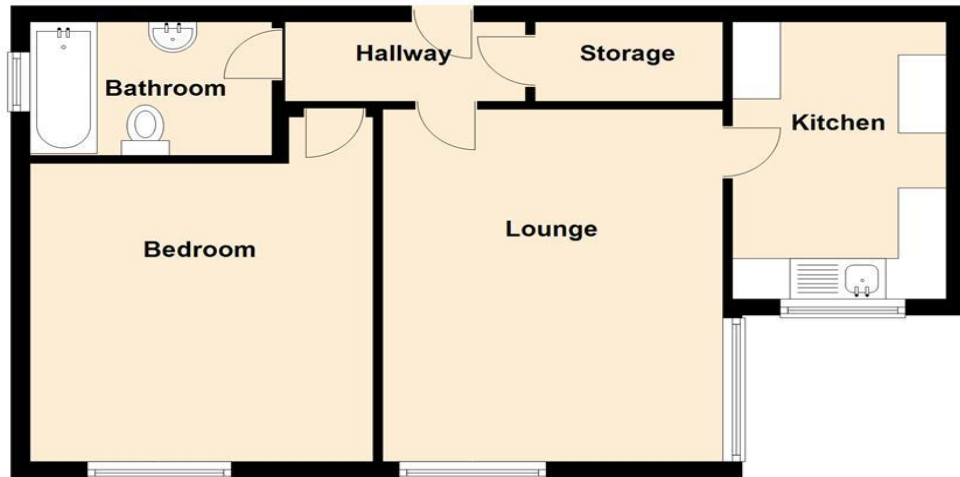

Total area: approx. 47.1 sq. metres (507.3 sq. feet)

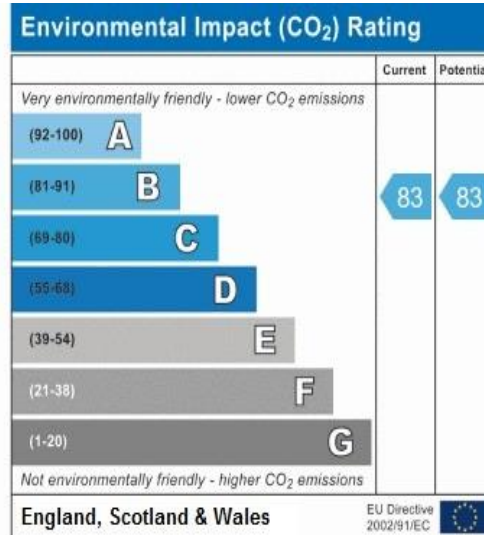
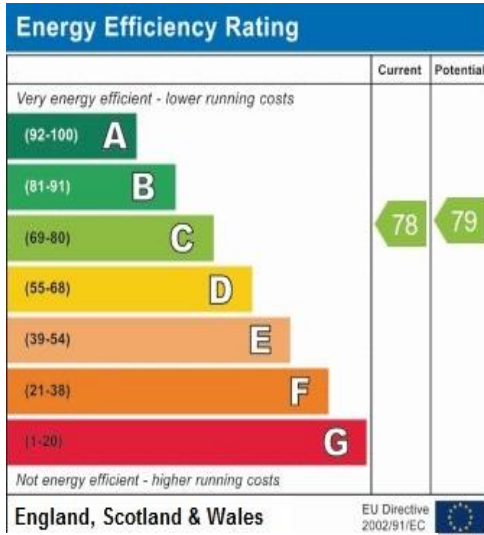

57 - 59 Ormskirk Road Saddle Junction  
Wigan WN5 9EA



01942 238 200



info@breakeyandco.com



www.breakeyandco.com